

CORNER CONNECTOR

8mm Corner Feed connector - 15cm Lead



Our innovative Mini connectors are compatible with all single colour 8mm strips and designed to fit into even the slimmest aluminium extrusions.

These Corner connectors are used to go around bends; simply insert the strip into the corresponding terminals and crimp with pliers to pierce PCB components for a secure finish- **see page 2 for full instructions.**

PRODUCT SPECIFICATION

COMPATIBLE STRIP SERIES (IP20):	ECO COB
STRIP PCB WIDTH:	8mm
VOLTAGE RANGE:	DC 3-24V
MAX LOAD RATING:	96W (24V)
WIRE ACCEPTED:	Pre-Flexed with a 15cm lead (Red & Black)
DIMENSIONS:	L15.6*W9.6*H3.3mm
PRODUCT REFERENCE:	FLSC8SML

CORNER CONNECTOR

8mm Corner Feed connector - 15cm Lead

USING A CORNER CONNECTOR

Our corner connectors eliminate the need for soldering. Please follow the steps explained below, repeating the same process for each connector:

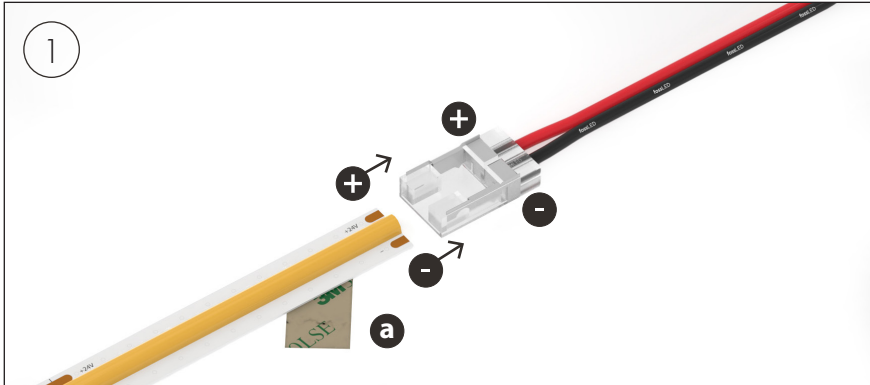

a Peel back the adhesive tape leaving a sufficient amount of bare strip to insert into the clip. Make sure you peel back the tape and accompanying adhesive layer leaving this to re-apply once the connection is complete.

+ - Align the LED Strip ensuring the polarities match with the feed cable.

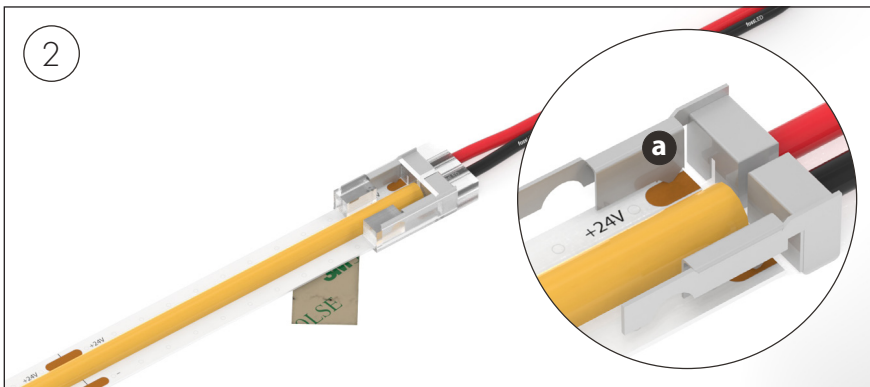

a Insert the LED Strip into the corresponding terminals ensuring the strip is fitted correctly so that the copper pads line up with the clip connector teeth.

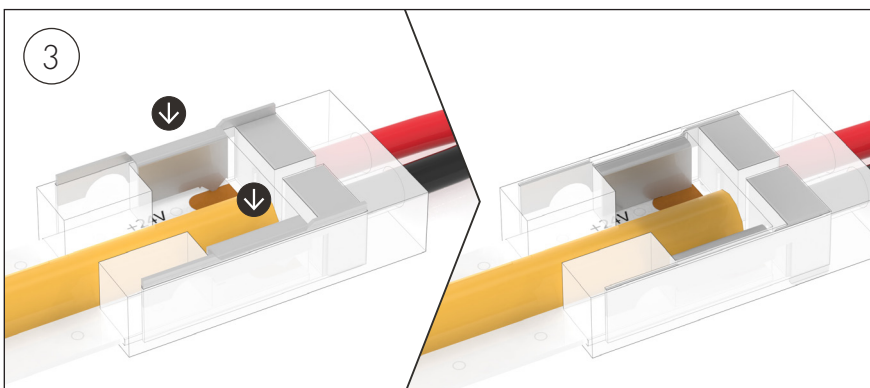

↓ Crimp down on the teeth prongs with pliers to pierce your LED Strip PCB leaving the prongs flush with the connector housing. Check the LED Strip is locked in and the connection is secure.

Re-apply the adhesive tape under the clip connector ready for installation.

Note: Care must be taken when crimping so as not to crack the outer housing.